

Flyerketten, leichte Bauart nach amerik. Norm (AL) und europ. Norm (LL)

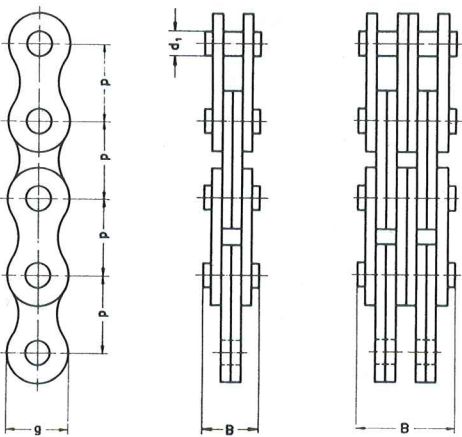

Standard-Laschenkombinationen Standard-Lacings



2 x 2

4 x 4

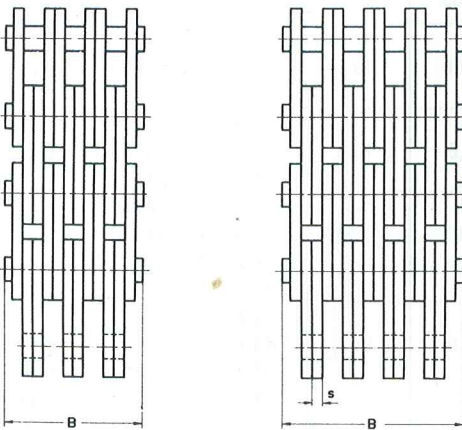

6 x 6

8 x 8

Befestigung von Flyerketten KOMBINATIONEN

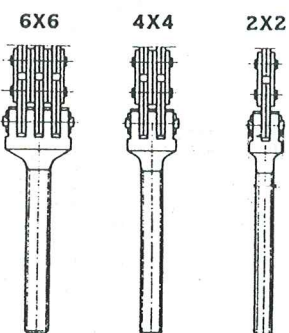

6x6

4x4

2x2

| BDAT Nr. | Teilung | Laschen kombination | Bolzen Ø | Laschen- dicke | Laschen- breite | Gesamt- breite | Bruch- kraft | Gewicht ca. |
|-------------|----------|------------------------|-----------------------|--------------------|-----------------------|------------------------|------------------|-------------------|
| | Pitch | Lacing | Pin Diameter | Plate Thickness | Plate Depth | Pin Length | Breaking Load | Approx. Weight |
| | p mm | | d _{1max.} mm | s(max.) mm | g _{1max.} mm | B _(max.) mm | DIN min.N | kg/m |
| AL 622 | | 2 x 2 | | | | 12,4 | 37 000 | 0,86 |
| 644 | 19,05 | 4 x 4 | 5,92 | 2,44 | 15,3 | 22,4 | 64 000 | 1,69 |
| 666 | (3/4") | 6 x 6 | | | | 32,4 | 101 000 | 2,52 |
| 688 | | 8 x 8 | | | | 42,2 | 138 000 | 3,34 |
| 1922 | 19,05 | 2 x 2 | 5,72 | 1,83 | 16,1 | 10,7 | 29 500 | 0,60 |
| 1944 | (3/4") | 4 x 4 | | | | 18,5 | 59 000 | 1,18 |
| 1966 | | 6 x 6 | | | | 26,3 | 88 500 | 1,78 |
| AL 822 | 25,4 | 2 x 2 | 7,94 | 3,1 | 20,7 | 16,0 | 56 700 | 1,54 |
| 844 | (1") | 4 x 4 | | | | 29,3 | 113 400 | 3,00 |
| 866 | | 6 x 6 | | | | 42,4 | 170 100 | 4,46 |
| 2522 | | 2 x 2 | | | | 17,2 | 58 000 | 1,78 |
| 2544 | 25,4 | 4 x 4 | 8,28 | 3,0 | 21,1 | 30,2 | 116 000 | 2,85 |
| 2566 | (1") | 6 x 6 | | | | 43,2 | 174 000 | 4,59 |
| 2588 | | 8 x 8 | | | | 55,6 | 232 000 | 5,66 |
| AL 1022 | | 2 x 2 | | | | 19,6 | 88 500 | 2,37 |
| 1044 | 31,75 | 4 x 4 | 9,50 | 4,01 | 25,6 | 35,94 | 177 000 | 4,68 |
| 1066 | (1 1/4") | 6 x 6 | | | | 52,33 | 265 000 | 7,00 |
| 1088 | | 8 x 8 | | | | 68,71 | 354 000 | 9,31 |
| 3122 | | 2 x 2 | | | | 20,1 | 95 000 | 2,15 |
| 3144 | 31,75 | 4 x 4 | 10,19 | 3,7 | 26,4 | 35,1 | 190 000 | 4,25 |
| 3166 | (1 1/4") | 6 x 6 | | | | 50,0 | 285 000 | 6,40 |
| 3188 | | 8 x 8 | | | | 64,8 | 380 000 | 8,48 |
| AL 1222 | | 2 x 2 | | | | 24,27 | 127 000 | 3,65 |
| 1244 | 38,1 | 4 x 4 | 11,11 | 4,83 | 30,5 | 43,83 | 254 000 | 7,05 |
| 1266 | (1 1/2") | 6 x 6 | | | | 62,96 | 381 000 | 10,44 |
| 3822 | | 2 x 2 | | | | 28,4 | 170 000 | 4,24 |
| 3844 | | 4 x 4 | | | | 49,4 | 340 000 | 8,04 |
| 3866 | 38,1 | 6 x 6 | 14,63 | 5,13 | 33,7 | 70,4 | 510 000 | 11,50 |
| 3888 | (1 1/2") | 8 x 8 | | | | 91,0 | 680 000 | 15,94 |
| 381010 | | 10 x 10 | | | | 111,5 | 900 000 | 19,88 |
| 381212 | | 12 x 12 | | | | 132,0 | 1080 000 | 23,00 |
| AL 1422 | | 2 x 2 | | | | 28,13 | 186 000 | 4,67 |
| 1444 | 44,45 | 4 x 4 | 12,69 | 5,61 | 35,6 | 50,78 | 372 000 | 9,12 |
| 1466 | (1 3/4") | 6 x 6 | | | | 73,58 | 558 000 | 13,64 |
| 4422 | | 2 x 2 | | | | 34,0 | 200 000 | 5,35 |
| 4444 | 44,45 | 4 x 4 | 15,92 | 6,43 | 37,1 | 60,0 | 400 000 | 10,48 |
| 4466 | (1 3/4") | 6 x 6 | | | | 86,0 | 600 000 | 15,60 |
| 4488 | | 8 x 8 | | | | 112,0 | 800 000 | 20,72 |
| AL 1622 | | 2 x 2 | | | | 31,9 | 214 800 | 5,79 |
| 1644 | 50,8 | 4 x 4 | 14,24 | 6,43 | 40,7 | 57,8 | 428 000 | 11,44 |
| 1666 | (2") | 6 x 6 | | | | 83,7 | 642 000 | 17,09 |
| 1688 | | 8 x 8 | | | | 109,6 | 856 000 | 22,74 |
| 161010 | | 10 x 10 | | | | 135,5 | 1070 000 | 28,42 |
| 5022 | | 2 x 2 | | | | 35,0 | 260 000 | 5,81 |
| 5044 | 50,8 | 4 x 4 | 17,78 | 6,43 | 42,3 | 61,0 | 520 000 | 11,46 |
| 5066 | (2") | 6 x 6 | | | | 87,0 | 780 000 | 17,11 |
| 5088 | | 8 x 8 | | | | 113,0 | 1040 000 | 22,76 |
| LL 4022 | | 2 x 2 | | | | 44,7 | 360 000 | 9,75 |
| 4044 | 63,5 | 4 x 4 | 22,91 | 8,00 | 53,0 | 77,9 | 720 000 | 19,35 |
| 4066 | (2 1/2") | 6 x 6 | | | | 111,1 | 1080 000 | 28,95 |
| 4088 | | 8 x 8 | | | | 144,3 | 1440 000 | 38,55 |
| 7622 | | 2 x 2 | | | | 56,1 | 560 000 | 14,75 |
| 7644 | 76,2 | 4 x 4 | 29,26 | 10,20 | 63,9 | 97,4 | 1120 000 | 28,75 |
| 7666 | (3") | 6 x 6 | | | | 138,9 | 1680 000 | 42,80 |

Flyerketten, leichte Bauart nach amerik. Norm (AL) und europ. Norm (LL)



Standard-Laschenkombinationen Standard-Lacings

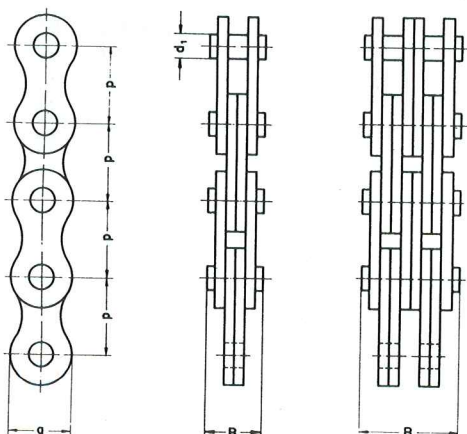

2 x 2

4 x 4

Anschlußbolzen

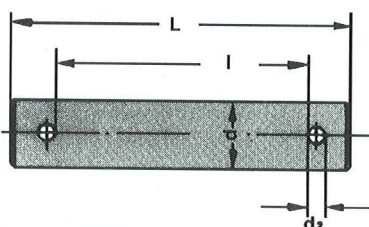

Flyerkette in gebuchster Ausführung „B“

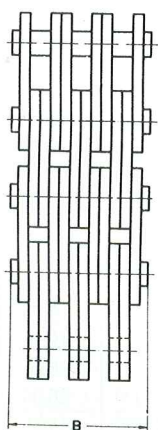

6 x 6

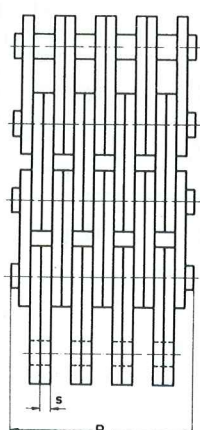

8 x 8

Flyerketten Baureihe AL und LL

AL und LL-Flyerketten sind in Laschenkombinationen lieferbar, die hohe Dauerfestigkeitswerte bei geringem Eigengewicht der Kette erreichen. Diese Ketten werden bevorzugt dort eingesetzt, wo es auf geringes Eigengewicht des Zugelementes ankommt, wie beispielsweise bei Kranauslegern, Gabelstaplern usw.

Die AL-Serie entspricht der ANSI B 29.8-1958 „AL“ Norm, hat jedoch zusätzlich 2 x 2 und 8 x 8 Laschenkombinationen in allen Größen.

‘AL’ and ‘LL’ Series Chains

These chains all utilise standard Roller Chain Outer Links in their construction. Standard Chains laced with links in pairs to give high Tensile Strength in combination with low weight. This makes these chains popular selection for applications where high load carrying is required but little shock load occurs. Many chains conform to ANSI B 29.8-1958 ‘AL’ or ISO 4347 ‘LL’ specification.

| BDAT Nr. | Teilung | Laschenkombination | Bolzen Ø | Laschen- dicke | Laschen- höhe | Gesamt- breite | Bruch- kraft | Gewicht ca. | |
|-----------|---------|--------------------|----------------------|--------------------|------------------|-----------------------|------------------|-------------------|------|
| | Pitch | Lacing | Pin Diameter | Plate Thickness | Plate Depth | Pin Length | Breaking Load | Approx. Weight | |
| | p mm | | d _{1max} mm | s(max) mm | g(max) mm | B _(max) mm | DIN min. N | kg/m | |
| ● F19V-44 | 19,05 | 4 x 4 | 6,5 | 2,35 | 15,2 | 22,4 | 71 000 | 1,75 | |
| ● F19V-66 | | 6 x 6 | | | | 32,3 | 106 000 | 2,6 | |
| AL 422 | 12,70 | 2 x 2 | 3,97 | 1,50 | 10,4 | 7,9 | 14 100 | 0,39 | |
| 444 | (1/2") | 4 x 4 | | | | 14,4 | 28 200 | 0,74 | |
| 466 | | 6 x 6 | | | | 20,5 | 42 300 | 1,09 | |
| 1222 | 12,70 | 2 x 2 | 4,45 | 1,6 | 10,9 | 7,9 | 18 200 | 0,39 | |
| 1244 | (1/2") | 4 x 4 | | | | 14,4 | 36 400 | 0,67 | |
| 1266 | | 6 x 6 | | | | 20,5 | 54 600 | 0,97 | |
| AL 522 | 15,88 | 2 x 2 | 5,08 | 1,97 | 12,85 | 10,2 | 22 000 | 0,61 | |
| 544 | | 4 x 4 | | | | 18,9 | 44 000 | 1,19 | |
| 566 | | (5/8") | | | | 6 x 6 | 26,9 | 66 000 | 1,79 |
| 588 | | 8 x 8 | | | | 36,2 | 88 000 | 2,37 | |
| 1522 | 15,88 | 2 x 2 | 5,08 | 1,6 | 13,7 | 9,3 | 22 700 | 0,47 | |
| 1544 | 4 x 4 | 16,1 | | | | 45 400 | 0,92 | | |
| 1566 | (5/8") | 6 x 6 | | | | 22,9 | 68 100 | 1,38 | |
| 1588 | 8 x 8 | 28,0 | | | | 90 800 | 1,85 | | |
| 151212 | 12 x 12 | 40,5 | | | | 136 200 | 2,66 | | |

| Ketten Nr. | | Nenn- Teilung P | Laschen- kombi- nation | Laschen | | Bolzen Ø d2 mm | Breite üb. Laschen a max. mm | Kettenbr. = Bolzenlänge b max. mm | Bruchkraft Fa N | Gewicht kg/m |
|------------|---------|-----------------------|------------------------------|---------------|--------------|-------------------|------------------------------------|---|--------------------|-----------------|
| neu | alt | | | Dicke s mm | Höhe g mm | | | | | |
| 1544 B | 5844 B | 5/8" = | 4 x 4 | 1,7 | 13,8 | 5,08 | 14,2 | 16,6 | 46 000 | 1,13 |
| 1566 B | 5866 B | 15,875 | 6 x 6 | | | | 21,3 | 23,7 | 69 5000 | 1,6 |
| 1588 B | 5888 B | mm | 8 x 8 | | | | 28 | 30,6 | 92 700 | 2,3 |
| 1944 B | 3444 B | 3/4" = | 4 x 4 | 1,8 | 18,1 | 5,72 | 14,5 | 17,2 | 61 700 | 1,5 |
| 1966 B | 3466 B | | 6 x 6 | | | | 22,5 | 24,8 | 92 500 | 2,3 |
| 1944 BV | 4333 BV | | 19,05 | | | | 4 x 4 | 19 | 22,6 | 78 000 |
| 1966 BV | 3466 BV | mm | 6 x 6 | 28,2 | 31,8 | 117 000 | 2,9 | | | |
| 2544 B | 1044 B | 1" = | 4 x 4 | 3 | 24 | 8,27 | 25,8 | 29,5 | 120 000 | 3,4 |
| 2566 B | 1066 B | 25,4 | 6 x 6 | | | | 37,5 | 41,7 | 180 000 | 5,1 |
| 2588 B | 1088 B | mm | 8 x 8 | | | | 52,4 | 56,2 | 240 000 | 6,8 |